











### LEGEND

- |                          |   |
|--------------------------|---|
| State Trunkline          |  |
| County Primary           |  |
| County Local             |  |
| Railroad                 |  |
| City or Village Street   |  |
| Township Line            |  |
| City or Village Boundary |  |
| Lake/River               |  |

PRIMARY ROAD SYSTEM IS 22.56 MILES

LOCAL ROAD SYSTEM IS 13.11 MILES

I HEREBY CERTIFY THAT THE ROADS SHOWN  
HEREON BY SYMBOL AS LOCAL ROADS ARE IN  
USE AND ARE UNDER THE JURISDICTION OF THE  
COUNTY ROAD COMMISSION.

**ANN ARBOR  
TWP.**

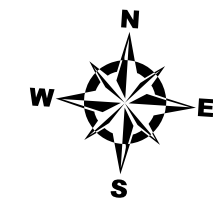

0 0.5 1 Miles

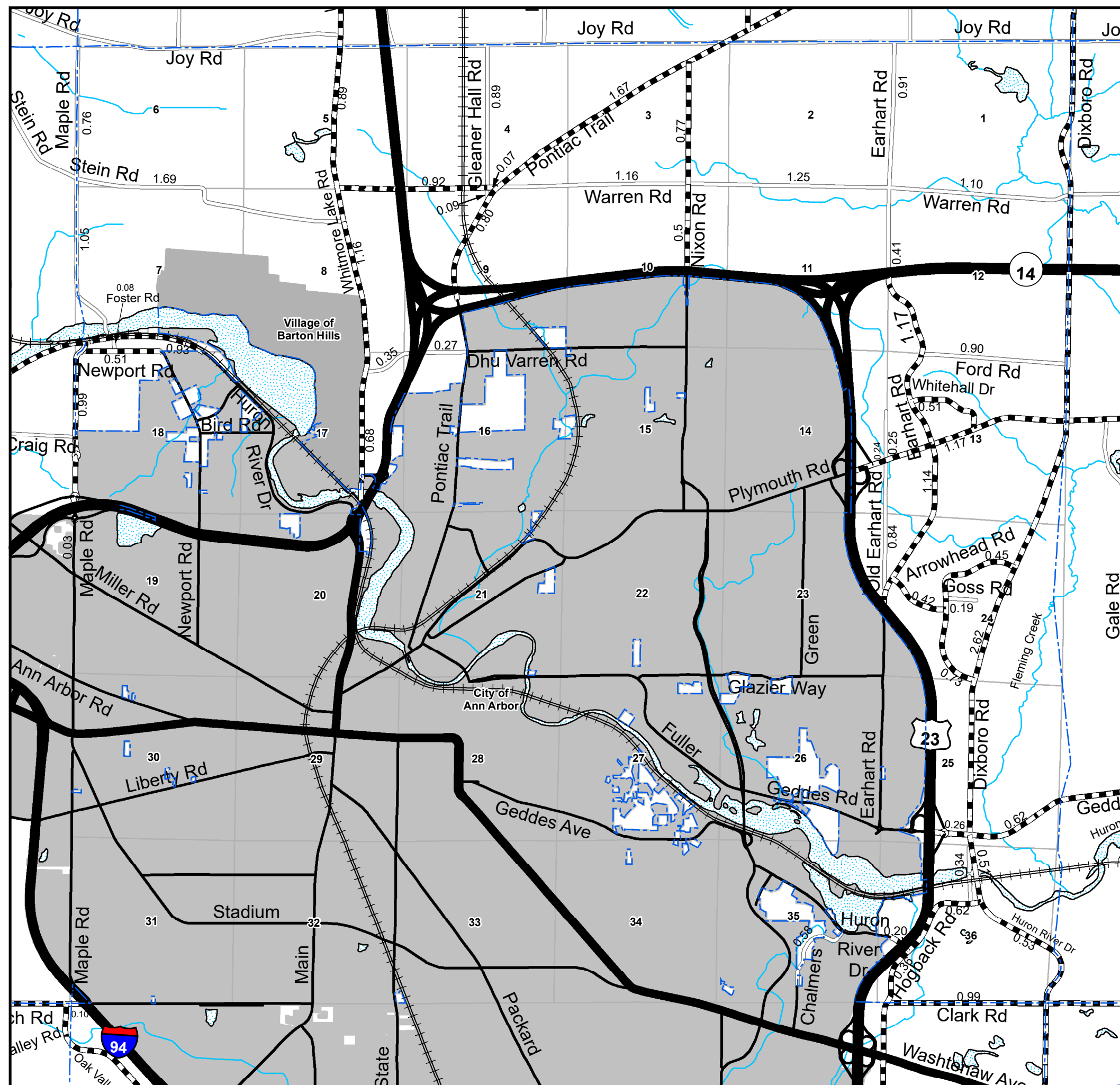

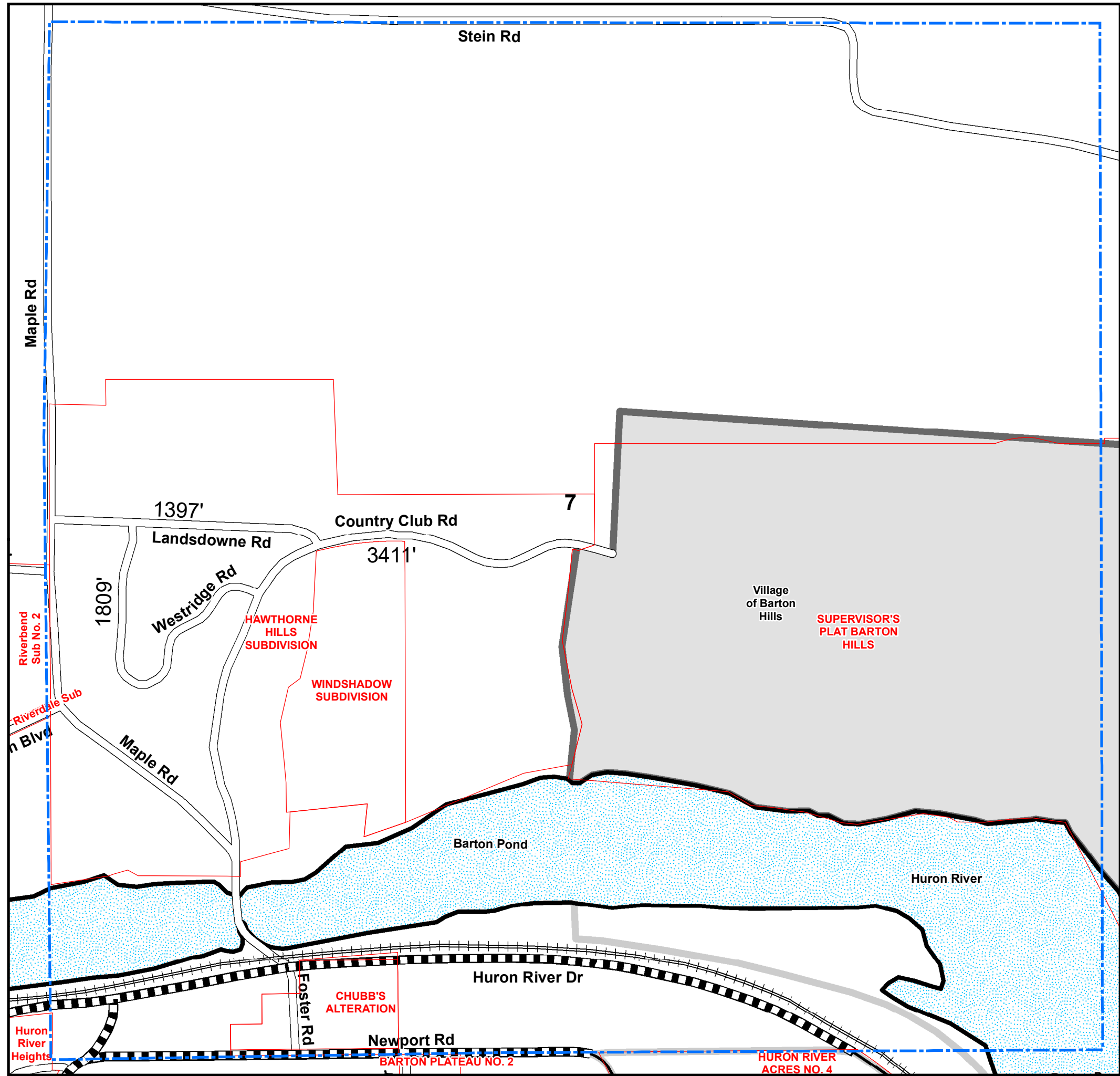

LEGEND

State Trunkline	
County Primary	
County Local	
Railroad	
City or Village Street	
Section Line	
City or Village Boundary	
Lake/River	

Total Feet 6,617 Equals 1.25 Miles

I HEREBY CERTIFY THAT THE ROADS SHOWN  
HEREON BY SYMBOL AS LOCAL ROADS ARE IN  
USE AND ARE UNDER THE JURISDICTION OF THE  
COUNTY ROAD COMMISSION.

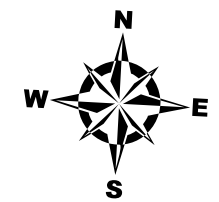

0 500 1,000 Feet

Township ANN ARBOR

Section 7 T 2S R 5E

County WASHTENAW



LEGEND

- State Trunkline
- County Primary
- County Local
- Railroad
- City or Village Street
- Section Line
- City or Village Boundary
- Lake/River

Total Feet 724 Equals 0.14 Miles

I HEREBY CERTIFY THAT THE ROADS SHOWN  
HEREON BY SYMBOL AS LOCAL ROADS ARE IN  
USE AND ARE UNDER THE JURISDICTION OF THE  
COUNTY ROAD COMMISSION.

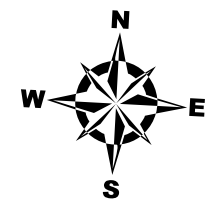

0 500 1,000 Feet

Township ANN ARBOR  
Section 8 & 17 T 2S R 5E  
County WASHTENAW

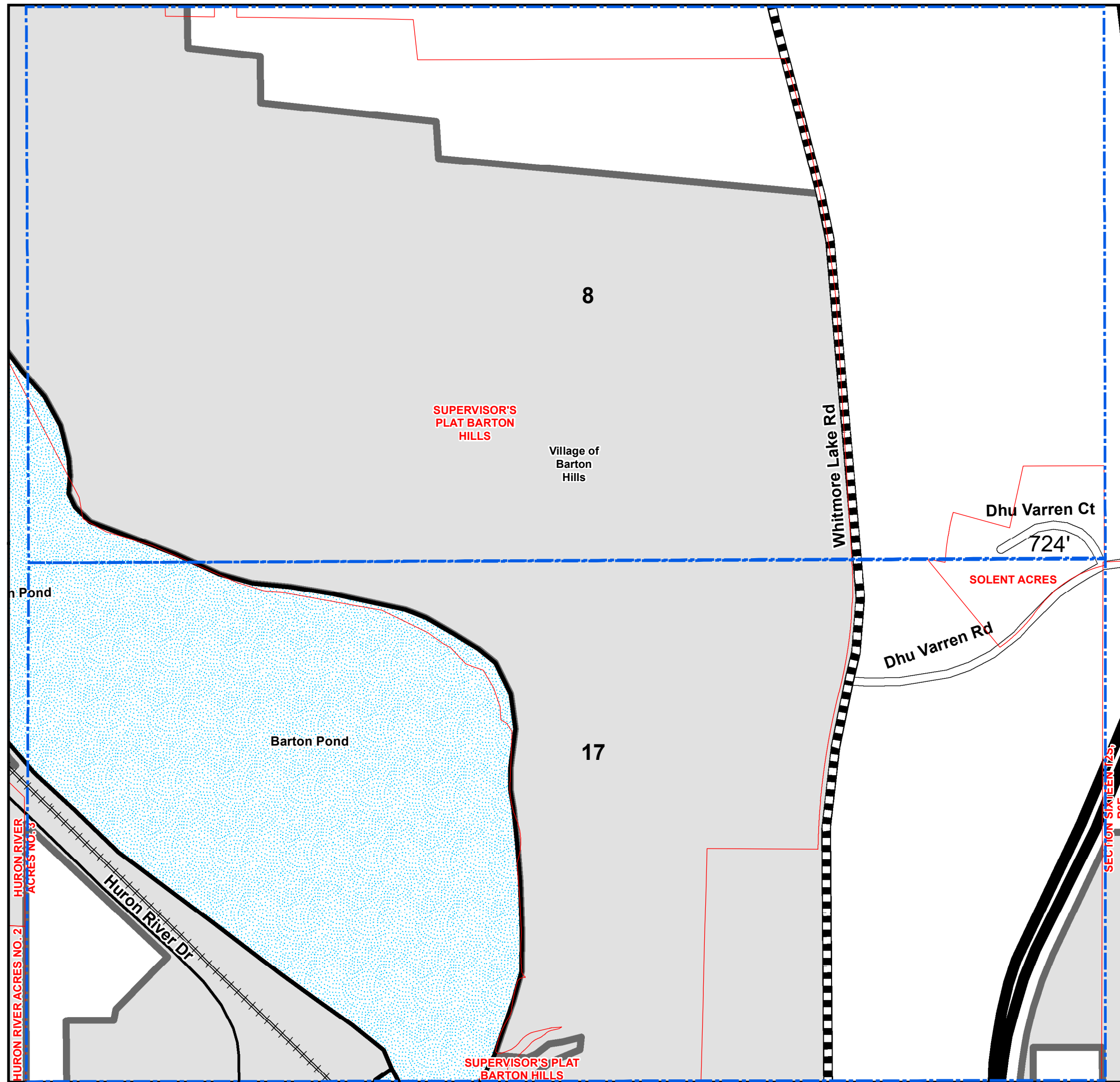



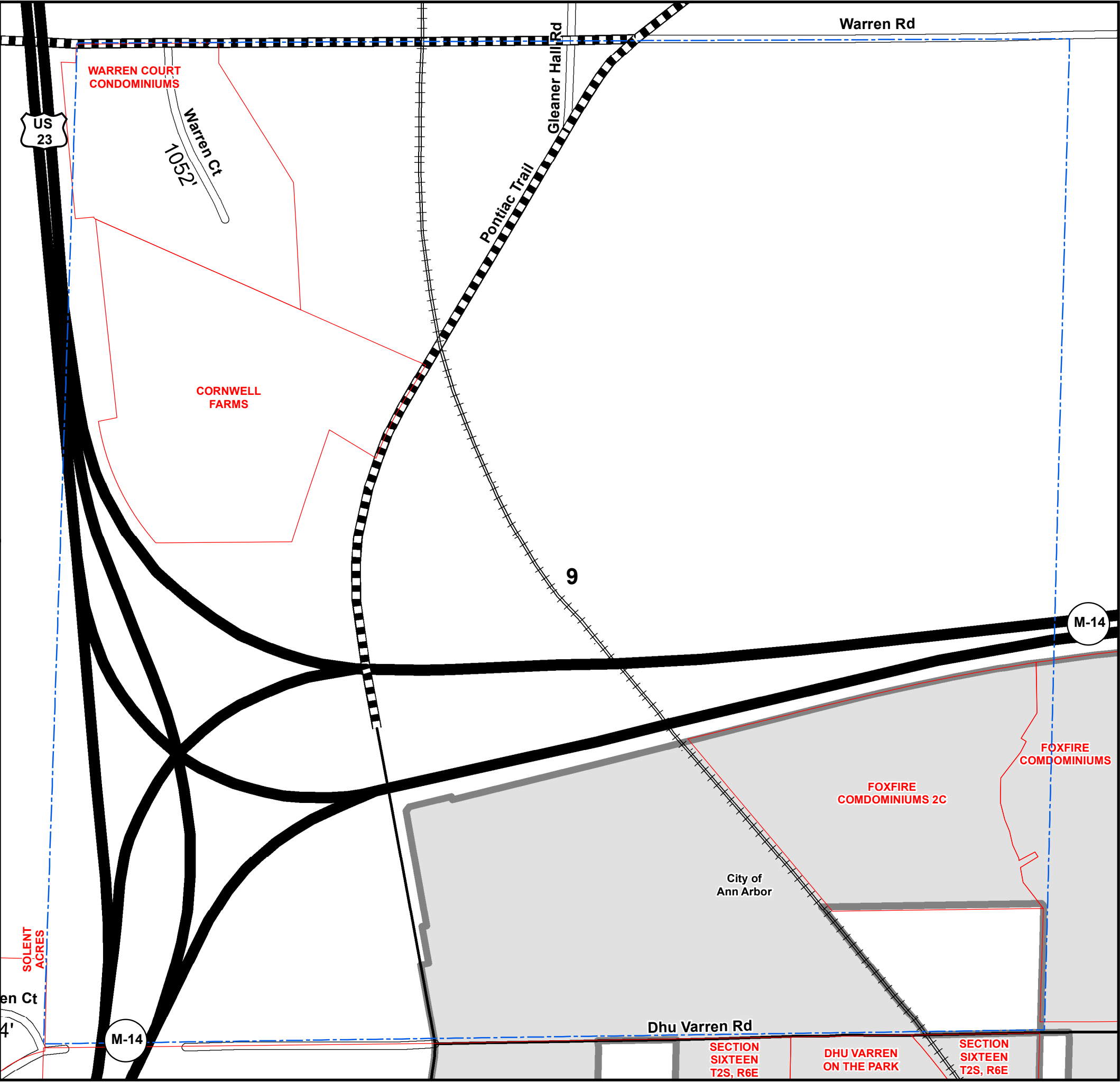

LEGEND

- State Trunkline
- County Primary
- County Local
- Railroad
- City or Village Street
- Section Line
- City or Village Boundary
- Lake/River

Total Feet 1,052 Equals 0.20 Miles

I HEREBY CERTIFY THAT THE ROADS SHOWN  
HEREON BY SYMBOL AS LOCAL ROADS ARE IN  
USE AND ARE UNDER THE JURISDICTION OF THE  
COUNTY ROAD COMMISSION.

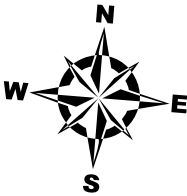

0 500 1,000 Feet

Township ANN ARBOR  
Section 9 T 2S R 5E  
County WASHTENAW

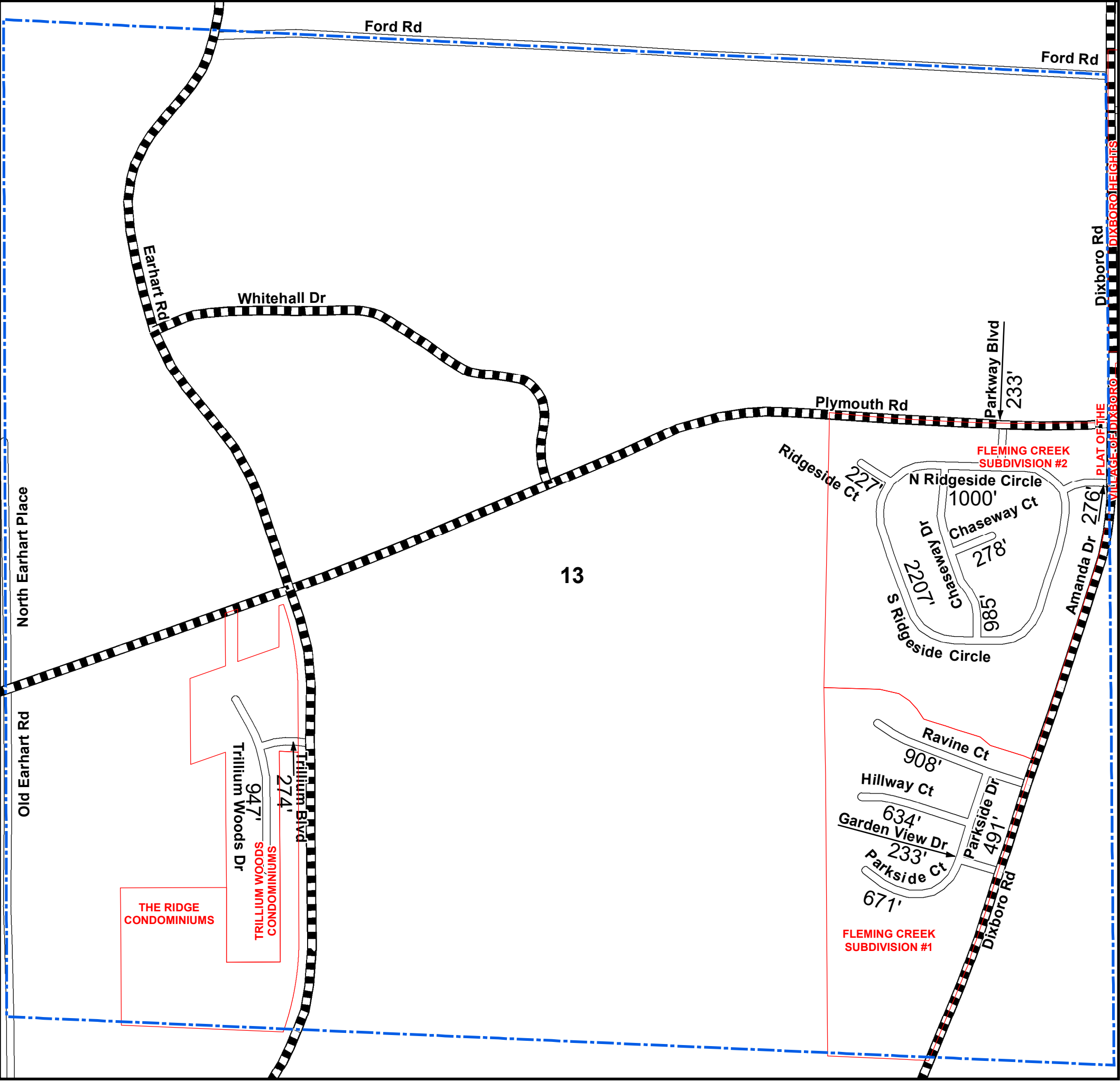

LEGEND

- State Trunkline
- County Primary
- County Local
- Railroad
- City or Village Street
- Section Line
- City or Village Boundary
- Lake/River

Total Feet 9,364 Equals 1.77 Miles

I HEREBY CERTIFY THAT THE ROADS SHOWN  
HEREON BY SYMBOL AS LOCAL ROADS ARE IN  
USE AND ARE UNDER THE JURISDICTION OF THE  
COUNTY ROAD COMMISSION.

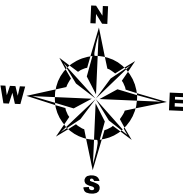

0 500 1,000 Feet

Township ANN ARBOR  
Section 13 T 2S R 5E  
County WASHTENAW

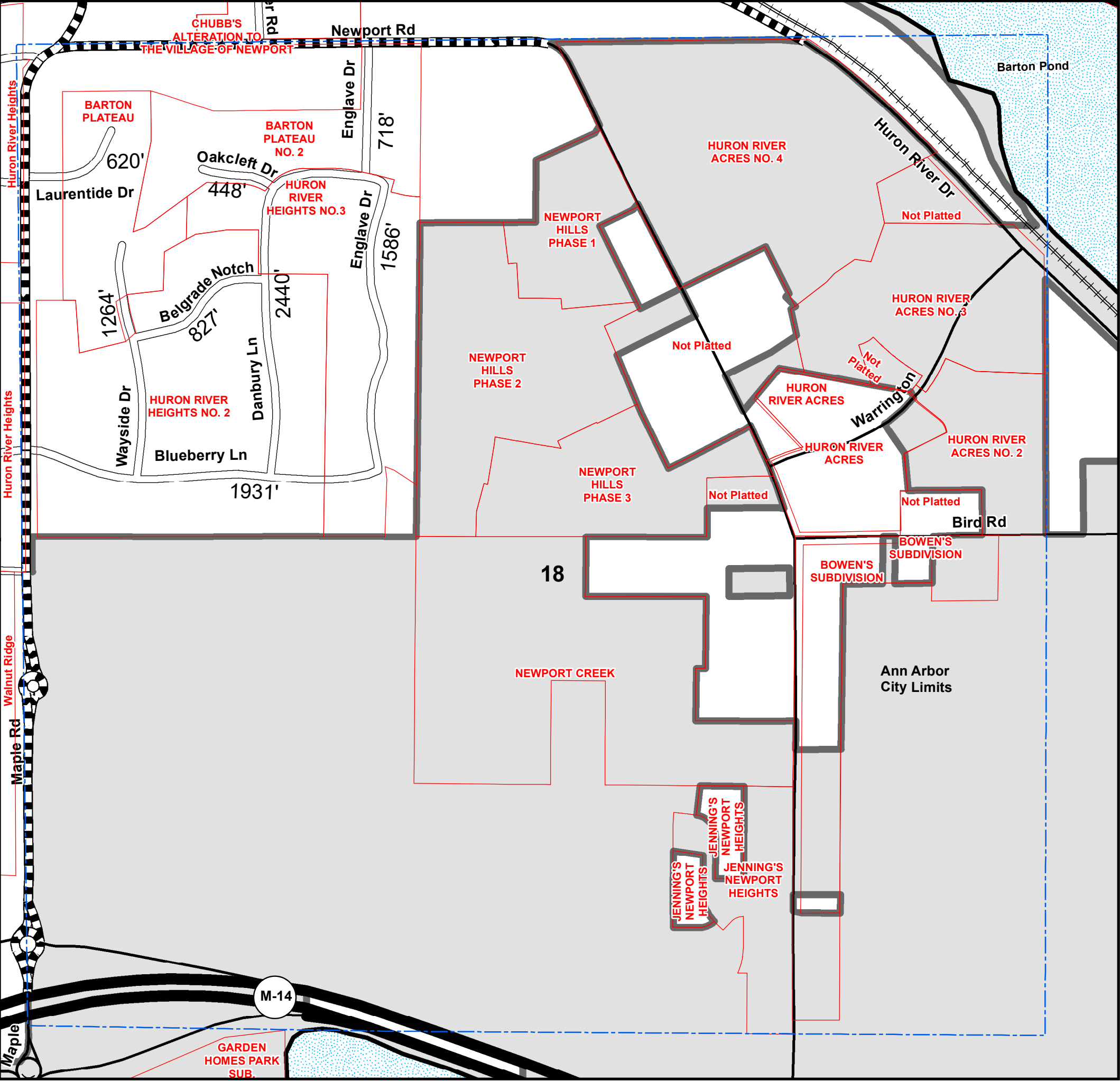

**LEGEND**

State Trunkline

County Primary

County Local

Adjacent County

City or Village Street

Section Line

City or Village Boundary

Lake/River

Total Feet 9,834 Equals 1.86 Miles

I HEREBY CERTIFY THAT THE ROADS SHOWN  
HEREON BY SYMBOL AS LOCAL ROADS ARE IN  
USE AND ARE UNDER THE JURISDICTION OF THE  
COUNTY ROAD COMMISSION.

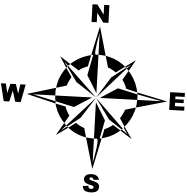

0 500 1,000 Feet

Township ANN ARBOR  
Section 18 T 2S R 5E  
County WASHTENAW

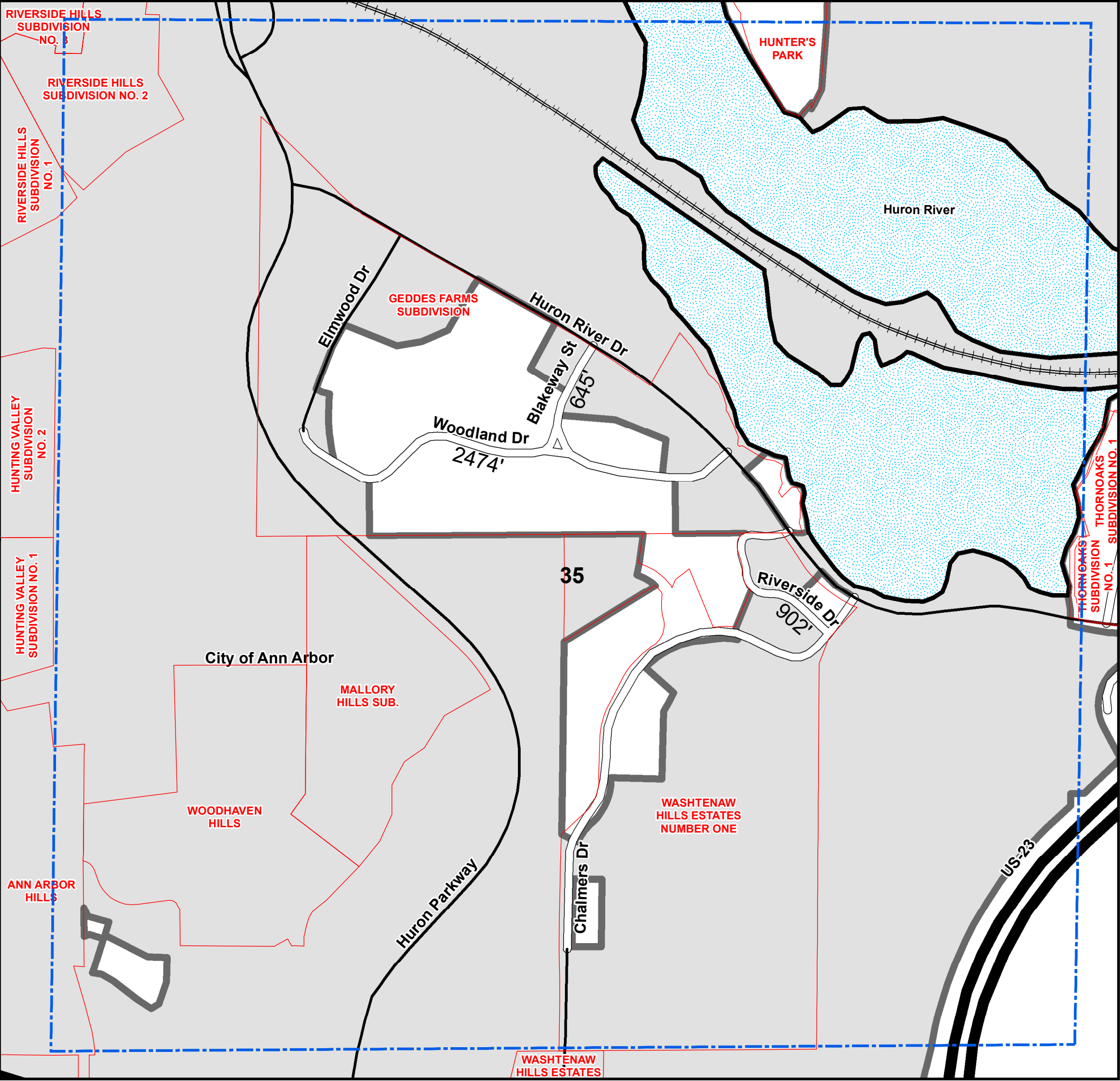

LEGEND

- State Trunkline
- County Primary
- County Local
- Railroad
- City or Village Street
- Section Line
- City or Village Boundary
- Lake/River

Total Feet 4,021 Equals 0.76 Miles

I HEREBY CERTIFY THAT THE ROADS SHOWN  
HEREON BY SYMBOL AS LOCAL ROADS ARE IN  
USE AND ARE UNDER THE JURISDICTION OF THE  
COUNTY ROAD COMMISSION.

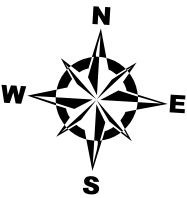

0 500 1,000  
 Feet

Township ANN ARBOR  
Section 35 T 2S R 5E  
County WASHTENAW



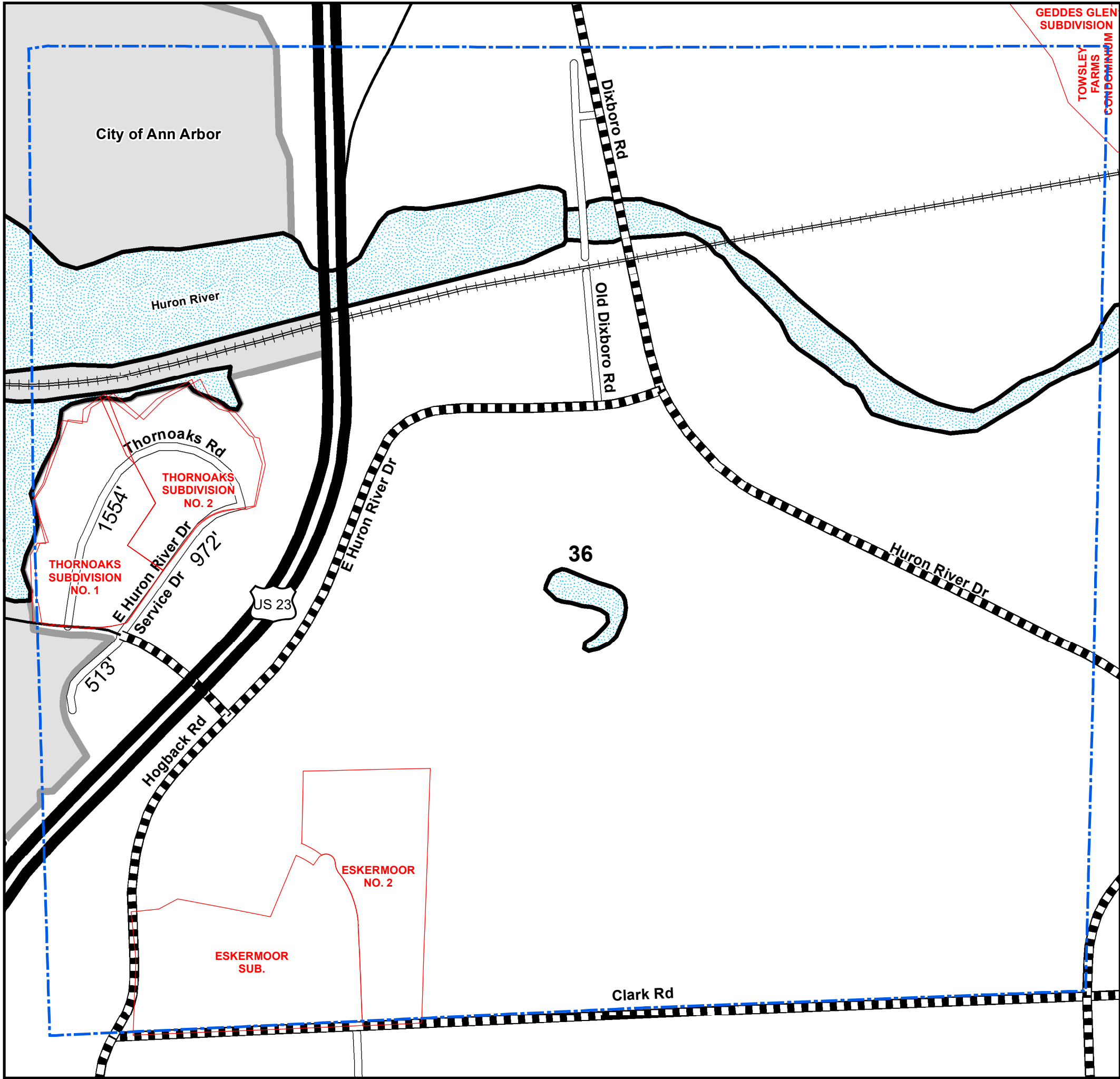

LEGEND

- State Trunkline
- County Primary
- County Local
- Railroad
- City or Village Street
- Section Line
- City or Village Boundary
- Lake/River

Total Feet 3,039 Equals 0.58 Miles

I HEREBY CERTIFY THAT THE ROADS SHOWN  
HEREON BY SYMBOL AS LOCAL ROADS ARE IN  
USE AND ARE UNDER THE JURISDICTION OF THE  
COUNTY ROAD COMMISSION.

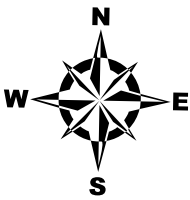

0 500 1,000 Feet

Township ANN ARBOR  
Section 36 T 2S R 5E  
County WASHTENAW